



FFU StarterKit 230V  
Notes on Use and Installation

## Safety information



### ATTENTION!

- Do not use outdoors.
- Do not connect the power line to the mains until you can guarantee a safe operation
- The company-internal regulations and the guidelines of the country of use must be observed.
- Unauthorized constructional modifications to the FFU StarterKit 230V are not permitted.
- If you are going to be absent for a longer period of time, switch off the unit or disconnect it from the power supply.
- Assembly, commissioning and electrical installation may only be carried out by trained qualified personnel.
- The FFU StarterKit 230V may only be operated in the designated areas and power ratings.
- The operator is responsible for proper and safe operation.
- The green-yellow grounding cable on the Filter-Fan-Unit must be screwed tightly to the marked grounding screw.
- When using the FFU StarterKit 230V, depending on the mounting conditions, it is recommended to connect it to the FFU first before integrating the Fan-Filter-Unit 1200x600 into the system.

## FFU StarterKit 230V - 0.0.715.83

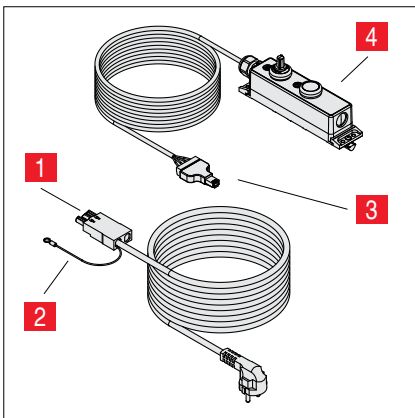

Connect the GST 18-3 connector system **1** and the RJ45 plug **3** of the control line to the socket provided for this purpose in the connection box of the FFU. The RJ45 plug **3** can be connected to any socket. The free socket can be used for series connection of further FFU's.



The grounding cable **2** of the power line must be firmly connected to the grounding screw of the FFU.

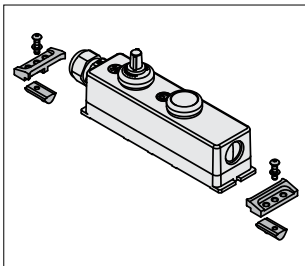
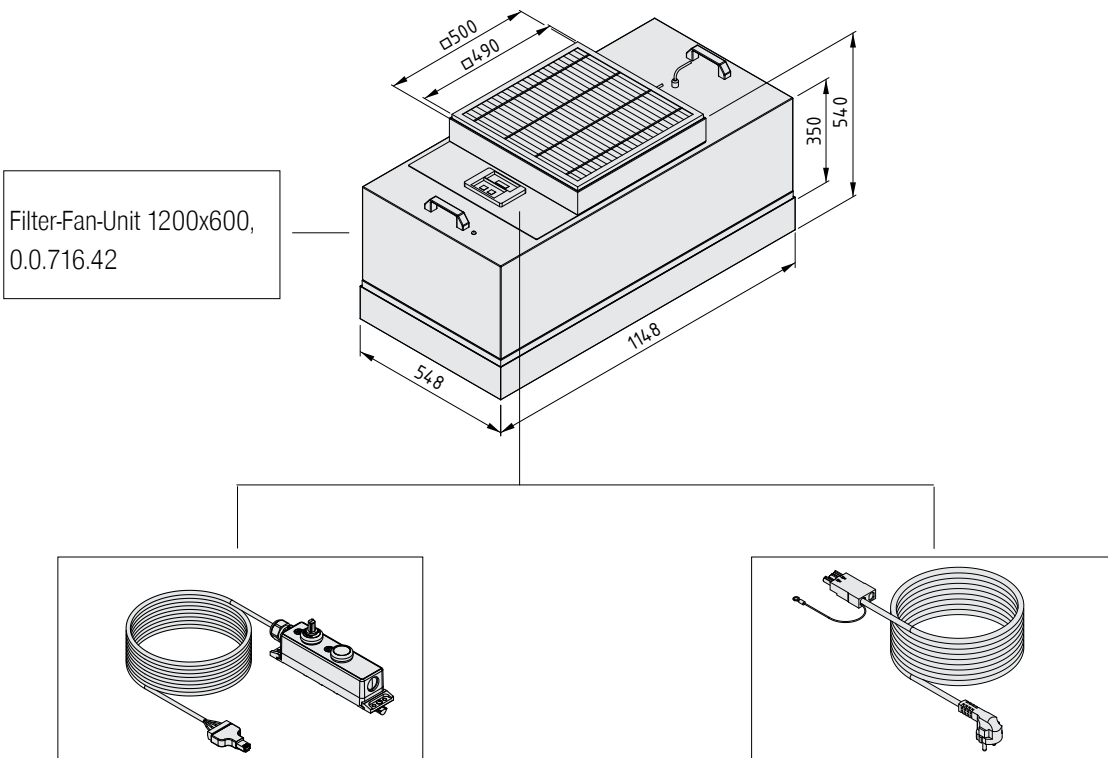

The control unit **4** with start/stop pressure switch as well as the potentiometer for regulating the volume flow can be easily mounted on a Profile line 8 (mounting material included in the scope of delivery) or used loosely as a manual control unit.

- Start or stop the FFU by pressing the pressure switch once. When starting, the FFU is ramped up to the preset value of the potentiometer. When stopping, the speed is regulated to zero. The pressure switch in the stop function does not de-energize the unit.
- The noise level increases significantly at higher outputs. The air flow and of the FFU are reduced significantly at lower outputs (turn potentiometer to the left).
- For continuous operation, we recommend setting the output to 50%. This corresponds, below the FFU, to an approximate air velocity of 0.45m/s, as specified in ISO 14644 for operation in cleanrooms. A regular filter check is recommended, as both the main filter and the pre-filter become clogged over time. In this case, the capacity must be set above the recommended 50% so that the air velocity is still approx. 0.45m/s.

## Documentation and development

A process of continuous product development ensures that products from item Industrietechnik GmbH always exhibit a high standard of innovation. Consequently, there could be inconsistencies between this guide and the product you have acquired. item Industrietechnik GmbH can also not exclude the possibility of errors. We therefore ask for your understanding that the information, illustrations and descriptions provided here cannot constitute an entitlement to any claims.

You can find the latest version of this user guide at [item24.com](http://item24.com).

**item**

item Industrietechnik GmbH  
Friedenstrasse 107-109  
42699 Solingen  
Germany  
Phone +49 212 6580 0  
info@item24.com  
item24.com

09/2022

Made in Germany

item Industrietechnik GmbH

0.0.716.59